





# Service Manual / Manuel de Service

## 10" Contractors' Cabinet Table Saw Banc de Scie à Cabinet 10" pour Contracteurs



Revised/Revisé 08/2008

### Internal Diagram/Diagramme Interne

# KC-10CCX

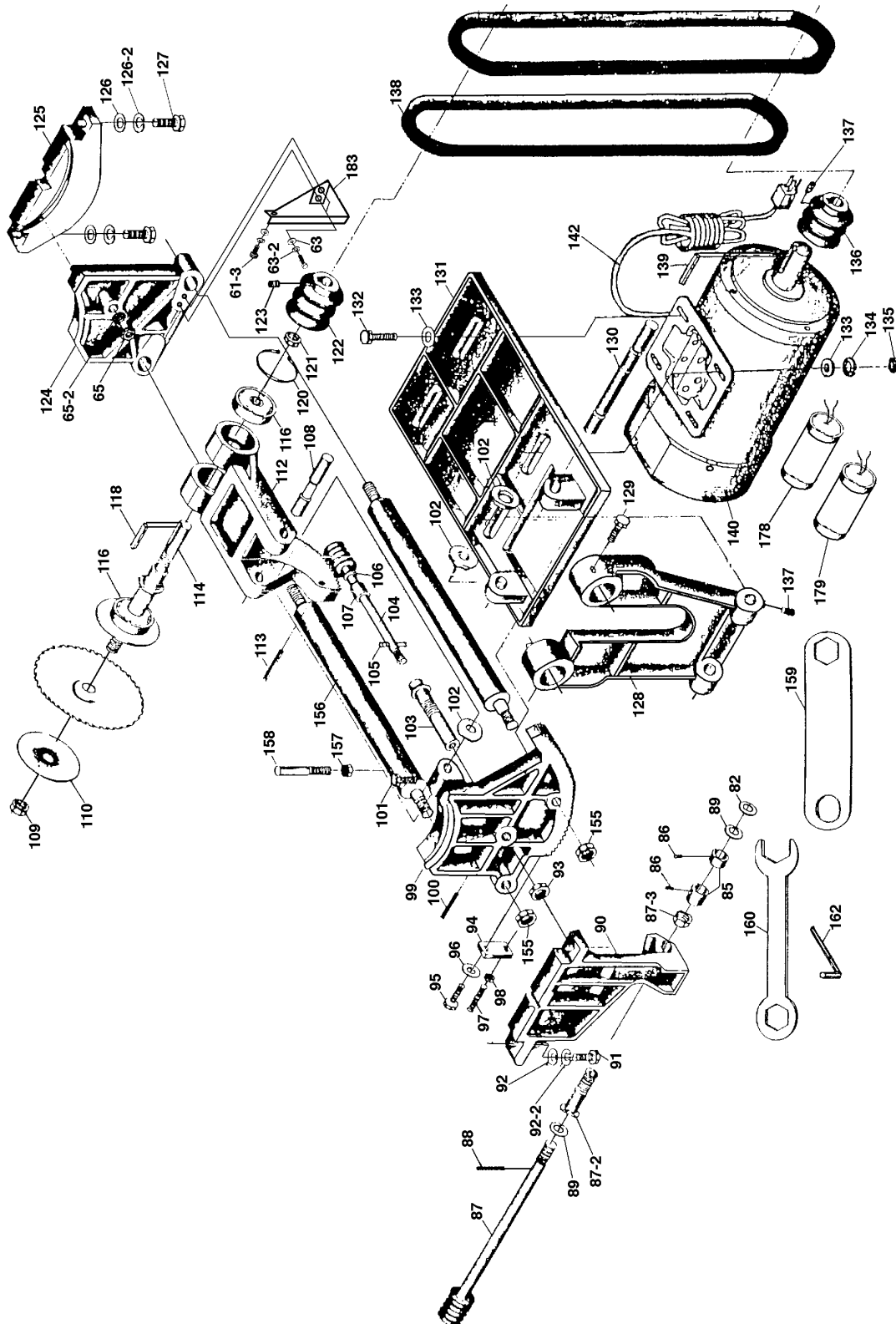



## ® Parts Pricing List / Liste de Prix des Pièces **KC-10CCX**

Diag.	Order # Com.	English Description	Description Française	Qty./Qté.	Price/Prix
1	KW-023	TABLE INSERT	INSERTION POUR TABLE	1	-
2	1103100020	BUMPER	PARE-CHOC	2	\$1.67
3	1103100030	SET SCREW	VIS SANS TETE	8	\$1.55
4	1103100040	TABLE	TABLE	1	\$396.75
5	1103100050	CABINET	CABINET	1	\$332.35
5-2	1103100052	RUBBER FOOT	PIED EN CAOUTCHOUC	4	\$3.16
5-3	1103100053	HEX. BOLT	BOULON HEXAGONAL	4	\$2.24
6	1103100060	WASHER	RONDELLE	8	\$1.55
6-2	1103100062	SPECIAL WASHER	RONDELLE SPECIALE	4	\$2.13
7	1103100070	HEX. BOLT	BOULON HEXAGONAL	4	\$1.67
8	1103100080	TILT SCALE	EHELLE D'INCLINAISON	1	\$10.29
10	EXT-10CCX	TABLE EXTENSION	EXTENSION DE TABLE	2	-
11	1103100110	SPRING WASHER	RONDELLE A RESSORT	6	\$1.55
12	1103100120	HEX. BOLT	BOULON HEXAGONAL	6	\$1.78
13	1103100130	HANDWHEEL BRACKET	SUPPORT DE LA MANIVELLE	1	\$12.36
14	1103100140	SCREW	VIS	2	\$1.67
15	1103100150	WASHER	RONDELLE	4	\$1.50
16	1103100160	HEX. NUT	ECROU HEXAGONAL	4	\$1.50
40-1	1103100401	PLASTIC BLADE GUARD	PROTEGE-LAME EN PLASTIQUE	1	\$38.81
42	1103100420	ROLL PIN (OLD)	GOUPILLE (ANC.)	1	\$2.70
42-1	1103100421	PIN	GOUPILLE	1	\$2.82
43	1103100430	WASHER (OLD)	RONDELLE (ANC.)	2	\$1.55
44	1103100440	LOCK NUT (OLD)	ECROU DE VERROUILLAGE (ANC.)	6	\$2.24
44-1	1103100441	LOCK NUT	ECROU DE VERROUILLAGE	4	\$2.24
47	1103100470	SUPPORTING ARM (OLD)	BRAS DE SUPPORT (ANC.)	1	\$10.98
47-1	1103100471	SUPPORT ARM	BRAS SUPPORT	1	\$9.83
48	1103100480	ROLL PIN (OLD)	GOUPILLE (ANC.)	1	\$2.70
49	1103100490	SPACER (OLD)	ESPACEUR (ANC.)	2	\$1.90
50	1103100500	ROLL PIN	GOUPILLE	1	\$2.24
56-1	1103100561	PIN	GOUPILLE	1	\$2.47
57	1103100570	SPLITTER (OLD)	SEPARATEUR (ANC.)	1	\$34.44
57-1	1103100571	SPLITTER	SEPARATEUR	1	\$3.16
57-2	1103100572	ANTI-KICKBACK PLATE (OLD)	DOIGT ANTI-RETOUR (ANC.)	2	\$4.89
57-3	1103100573	SPRING (OLD)	RESSORT (ANC.)	1	\$3.05
57-4	1103100574	SPRING PIN (OLD)	GOUPILLE A RESSORT (ANC.)	1	\$2.13
57-5	1103100575	ANTI-KICKBACK FINGER	DOIGT ANTI-RETOUR	2	\$5.58
57-6	1103100576	ANTI-KICKBACK SPRING	RESSORT ANTI-RETOUR	1	\$3.16
57-7	1103100577	SPRING PIN	GOUPILLE A RESSORT	1	\$2.13
57-8	1103100578	SPACER	ESPACEUR	2	\$2.13
61	1103100610	SHAFT BRACKET	SUPPORT DE LA TIGE	1	\$14.78
61-2	1103100612	SPLITTER BRACKET	SUPPORT DU SEPARATEUR	1	\$15.81
61-3	1103100613	HEX. BOLT	BOULON HEXAGONAL	5	\$1.67
62	1103100620	HEX. BOLT	BOULON HEXAGONAL	4	\$2.24
62-2	1103100622	HEX. NUT	ECROU HEXAGONAL	4	\$1.55
63	1103100630	WASHER	RONDELLE	11	\$1.55
63-2	1103100632	SPRING WASHER	RONDELLE A RESSORT	7	\$1.67
64	1103100640	BLADE GUARD SUPPORT SHAFT	TIGE DE SUPPORT DU PROTÈGE-LAME	1	\$13.74

Pricing subject to change without prior notice. / Prix sujet à changement sans préavis.



## Parts Pricing List / Liste de Prix des Pièces KC-10CCX

Diag.	Order # Com.	English Description	Description Française	Qty./Qté.	Price/Prix
65	1103100650	HEX. NUT	ECROU HEXAGONAL	1	\$1.67
65-2	1103100652	WASHER	RONDELLE	1	\$1.55
66	1103100660	WASHER	RONDELLE	1	\$1.67
67	1103100670	KNOB HANDLE	POIGNEE DU GUIDE	1	\$12.59
68	1103100680	HEX. NUT	ECROU HEXAGONAL	3	\$1.61
69	1103100690	RD HD SCREW	VIS A TETE RONDE	3	\$1.67
70	1103100700	MITER GAUGE BODY	CORPS DU GUIDE A ONGLETS	1	\$36.63
71	1103100710	SLIDING WASHER	RONDELLE COULISSANTE	1	\$3.28
71-2	1103100712	SINKING HD SCREW	VIS FRAISER	1	\$2.24
72	1103100720	MITER GAUGE BAR	BARRE DU GUIDE A ONGLETS	1	\$18.34
73	1103100730	LOCATING PLATE	PLAQUE D'ARRET	1	\$2.59
76	1103100760	POINTER	INDICATEUR	1	\$2.47
77	1103100770	SET SCREW	VIS SANS TETE	1	\$1.67
78	1103100780	SPRING PIN	GOUPILLE A RESSORT	1	\$1.61
80	1103100800	LOCK KNOB	BOUTON DE VERROUILLAGE	2	\$4.31
81	1103100810	DELUXE HANDWHEEL	MANIVELLE DE LUXE	2	\$39.04
81-2	1103100812	HANDLE KNOB	POIGNEE COMPLETE	2	\$6.84
82	1103100820	WASHER	RONDELLE	3	\$1.55
83	1103100830	POINTER	INDICATEUR	1	\$5.69
84	1103100840	SET SCREW	VIS SANS TETE	1	\$1.61
85	1103100850	COLLAR SET (2)	JEU DE BAGUE D'AJUSTEMENT (2)	1	\$4.54
86	1103100860	SET SCREW	VIS SANS TETE	2	\$1.61
87	1103100870	TILTING WORM SHAFT	TIGE D'INCLINAISON A ENGRENAGE	1	\$22.94
87-2	1103100872	ECCENTRIC BUSHING	BAGUE EXCENTRIQUE	1	\$11.44
87-3	1103100873	HEX. NUT	ECROU HEXAGONAL	1	\$2.19
88	1103100880	SPRING PIN	GOUPILLE A RESSORT	1	\$1.67
89	1103100890	FIBER WASHER	RONDELLE EN FIBRE	2	\$1.55
90	1103100900	FRONT BRACKET	SUPPORT AVANT	1	\$63.19
91	1103100910	HEX. BOLT	BOULON HEXAGONAL	2	\$1.90
92	1103100920	WASHER	RONDELLE	2	\$1.55
92-2	1103100922	SPRING WASHER	RONDELLE A RESSORT	2	\$1.61
93	1103100930	HEX. NUT	ECROU HEXAGONAL	1	\$3.05
94	1103100940	STOP BLOCK	BLOC D'ARRET	1	\$3.62
95	1103100950	HEX. BOLT	BOULON HEXAGONAL	1	\$2.01
96	1103100960	WASHER	RONDELLE	1	\$1.55
97	1103100970	SET SCREW	VIS SANS TETE	1	\$2.01
98	1103100980	HEX. NUT	ECROU HEXAGONAL	1	\$1.61
99	1103100990	FRONT TRUNNION	TOURILLON AVANT	1	\$45.83
100	1103101000	SPRING PIN	GOUPILLE A RESSORT	1	\$1.73
101	1103101010	HEX. BOLT	BOULON HEXAGONAL	1	\$1.73
102	1103101020	WAVE WASHER	RONDELLE ONDULEE	3	\$1.90
103	1103101030	ECCENTRIC SHAFT	TIGE EXCENTRIQUE	1	\$13.63
104	1103101040	ELEVATING SHAFT	TIGE D'ELEVATION	1	\$20.64
105	1103101050	SPRING PIN	GOUPILLE A RESSORT	1	\$1.73
106	1103101060	FIBER WASHER	RONDELLE EN FIBRE	1	\$1.61
107	1103101070	SPACER	ESPACEUR	1	\$2.70
108	1103101080	ARBOR BRACKET SHAFT	TIGE DU SUPPORT DE L'ARBRE	1	\$9.95

Pricing subject to change without prior notice. / Prix sujet à changement sans préavis.



## ® Parts Pricing List / Liste de Prix des Pièces **KC-10CCX**

Diag.	Order # Com.	English Description	Description Française	Qty./Qté.	Price/Prix
109	1103101090	ARBOR NUT	ECROU DE L'ARBRE	1	\$3.05
110	1103101100	FLANGE	RONDELLE DE LA LAME	1	\$7.88
111-1	1103101111	MITRE GAUGE ASS'Y	GUIDE A ONGLETS ASS.	1	\$68.94
112	1103101120	ARBOR BRACKET	SUPPORT DE L'ARBRE	1	\$56.18
113	1103101130	SPRING PIN	GOUPILLE A RESSORT	2	\$1.78
114	1103101140	BLADE ARBOR	ARBRE DE LA LAME	1	\$45.83
116	1103101160	BALL BEARING	ROULEMENT A BILLES	2	\$12.59
118	1103101180	KEY	CLE DE RETENUE	1	\$2.24
120	1103101200	RETAINING RING	ANNEAU DE RETENU	1	\$2.47
121	1103101210	HEX. NUT	ECROU HEXAGONAL	1	\$3.16
122	1103101220	ARBOR PULLEY	POULIE DE L'ARBRE	1	\$30.76
123	1103101230	SET SCREW	VIS SANS TETE	1	\$1.61
124	1103101240	REAR TRUNNION	TOURILLON ARRIERE	1	\$29.84
125	1103101250	REAR TRUNNION BRACKET	SUPPORT DU TOURILLON ARRIERE	1	\$25.13
126	1103101260	WASHER	RONDELLE	2	\$1.55
126-2	1103101262	SPRING WASHER	RONDELLE A RESSORT	2	\$1.61
127	1103101270	HEX. BOLT	BOULON HEXAGONAL	2	\$1.90
128	1103101280	MOTOR BRACKET	SUPPORT DU MOTEUR	1	\$41.23
129	1103101290	HEX. BOLT	BOULON HEXAGONAL	2	\$1.61
130	1103101300	MOTOR PLATE ROD	TIGE DE LA PLAQUE DU MOTEUR	1	\$22.94
131	1103101310	MOTOR PLATE	PLAQUE DU MOTEUR	1	\$38.93
132	1103101320	HEX. BOLT	BOULON HEXAGONAL	4	\$2.13
133	1103101330	WASHER	RONDELLE	8	\$1.55
134	1103101340	SPRING WASHER	RONDELLE A RESSORT	4	\$1.61
135	1103101350	HEX. NUT	ECROU HEXAGONAL	4	\$1.67
136	1103101360	MOTOR PULLEY	POULIE DU MOTEUR	1	\$30.88
137	1103101370	SET SCREW	VIS SANS TETE	2	\$1.55
138	1103101380	TOOTH V-BELT (HI-POWER)	COURROIE EN "V" DENTELEE	2	\$16.04
139	1103101390	KEY	CLE DE RETENUE	1	\$2.24
140	1103101400	MOTOR	MOTEUR	1	\$440.45
141	1103101410	POWER CORD	CORDON D'ALIMENTATION	1	\$14.78
142	1103101420	MOTOR CORD	CORDON DU MOTEUR	1	\$12.59
147-2	1103101472	STRAIN RELIEF	ATTACHE-FIL	1	\$2.47
147-3	1103101473	STRAIN RELIEF NUT	ECROU POUR L'ATTACHE-FIL	1	\$1.44
151	1103101510	ACCESS DOOR	PORTE D'ACCES	1	\$228.85
155	1103101550	HEX. NUT	ECROU HEXAGONAL	4	\$3.05
156	1103101560	TIE ROD	TIGE DE SERRAGE	2	\$26.28
157	1103101570	HEX. NUT	ECROU HEXAGONAL	1	\$1.61
158	1103101580	TIE ROD BOLT	BOULON DE LA TIGE DE SERRAGE	1	\$4.43
159	1103101590	ARBOR WRENCH	CLE DE L'ARBRE	1	\$11.10
160	1103101600	OPEN & CLOSED KEY (14-12mm)	CLE OUVERTE ET FERMEE (14-12mm)	1	\$9.03
162	1103101620	HEX. KEY	CLE HEXAGONALE	1	\$2.59
163	1103101630	PADDLE SWITCH (4 PRONG)	INTERRUPTEUR A PAGAIL (4 PATTES)	1	\$14.89
164	1103101640	SWITCH BOX	BOITE ELECTRIQUE	1	\$14.89
165	1103101650	MOTOR CORD OUTLET	SORTIE DU CORDON DU MOTEUR	1	\$3.74
166	1103101660	SWITCH MOUNT PLATE	PLAQUE DE MONTAGE D'INTERR.	1	\$7.99
167	1103101670	HEX. BOLT	BOULON HEXAGONAL	2	\$1.61

Pricing subject to change without prior notice. / Prix sujet à changement sans préavis.



## ® Parts Pricing List / Liste de Prix des Pièces **KC-10CCX**

Diag.	Order # Com.	English Description	Description Française	Qty./Qté.	Price/Prix
168	1103101680	WASHER	RONDELLE	2	\$1.61
169	1103101690	SELF-TAPPING SCREW (POINTED)	VIS AUTOTARAUDEUSE (POINTUE)	3	\$1.90
170	1103101700	ACCESS DOOR HANDLE	POIGNEE PORTE D'ACCES	1	\$7.99
171	1103101710	HANDLE SHAFT	TIGE DE LA POIGNEE	1	\$4.54
172	1103101720	SPRING	RESSORT	1	\$8.80
173	1103101730	NYLON HEX. NUT	ECROU HEXAGONAL AVEC NYLON	1	\$1.78
174	1103101740	MITRE GAUGE SUPPORT	SUPPORT DU GUIDE A ONGLETS	1	\$6.15
175	1103101750	RIP FENCE SUPPORT	SUPPORT DU GUIDE A REFENDRE	2	\$6.15
176	1103101760	KEY HOOK	CROCHET POUR CLE	1	\$2.70
177	1103101770	PAN HD SCREW	VIS A TETE BOMBEE	8	\$1.67
177-2	1103101772	HEX. NUT	BOULON HEXAGONAL	8	\$1.55
178	1103101780	STARTING CAPACITOR	CONDENSATEUR DE DEMARRAGE	1	\$34.21
179	1103101790	RUNNING CAPACITOR	CONDENSATEUR D'OPERATION	1	\$29.84
180	1103101800	SWITCH KEY	CLE DE SECURITE DE L'INTERR.	1	\$3.39
181	1103101810	SPRING WASHER	RONDELLE A RESSORT	2	\$1.67
182-1	1103101821	SWITCH ASSEMBLY	INTERRUPTEUR ASSEMBLEE	1	\$63.19
183	1103101830	GUARD BRACKET	SUPPORT DE GARDE	1	\$34.21
333-3	1103103333	BLADE GUARD ASS'Y	PROTECTEUR DE LAME ASS.	1	\$113.68
	110310MBIL	BILINGUAL MANUAL KC-10CCX	MANUEL BILINGUE KC-10CCX	1	\$15.00